



MARINA
ONE

EVENT SPACES

IN THE HEART OF THE CITY

For enquiries

Call

6911 0391 / 6911 0110

Email

mscommunity@ms-developments.com

UNIQUE SPACES FOR ANY OCCASION

Marina One, an award-winning integrated development, within the prestigious Marina Bay financial district, ushers in a concept of living, working and entertaining at the heart of Singapore's vibrant new CBD. Set amidst an abundance of greenery, Marina One comes alive through the design of world-renowned architect Christoph Ingenhoven, a leader in sustainable Supergreen architecture and integrated development concepts. With a total gross floor area of approximately 3.67 million square feet, comprises close to 1.88 million square feet of prime Grade A office space, 140,000 square feet retail space of signature gastronomic offerings, retail and lifestyle services and 1,042 luxury residential apartments, Marina One is situated close to the Marina Bay, Downtown and upcoming Shenton Way MRT Stations, with easy access to major expressways.

Explore our selection of thoughtfully-designed and inspiring spaces that will make your event a truly memorable one. From cosy indoor modern meeting spaces to open venues for corporate events, live performances or product launches, our venues will make planning your next event a breeze.



MARINA ONE THE HEART

LEVEL 1

(City Room)

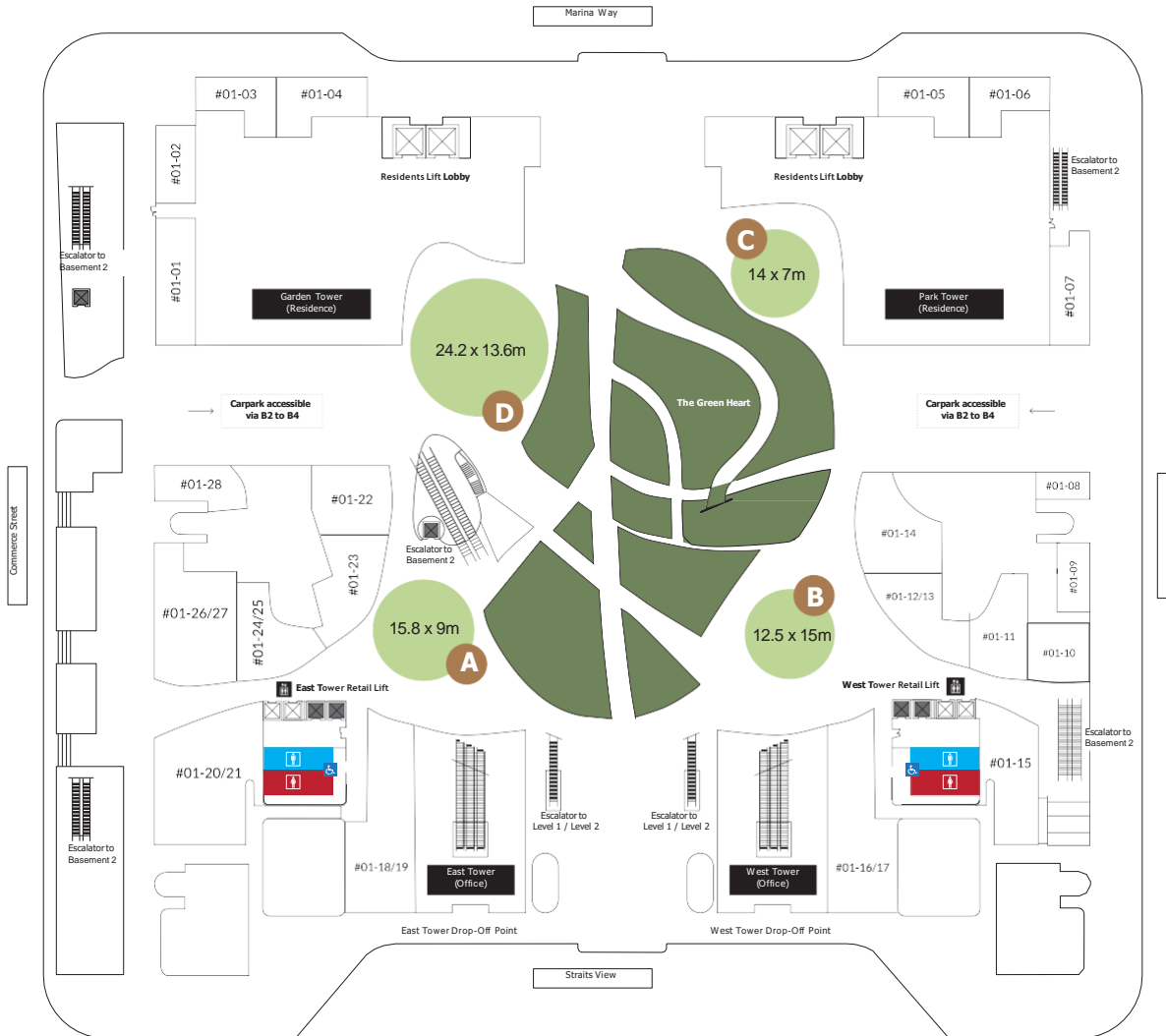

- A** CITY ROOM EAST TOWER
- B** CITY ROOM WEST TOWER
- C** CITY ROOM PARK TOWER
- D** CITY ROOM GARDEN TOWER

A

CITY ROOM EAST TOWER



SPECIFICATIONS

Dimensions:
15.8m x 9m

Capacity:
Approx. 100 pax standing

Features:
Sheltered & natural cooling from
Marina One's Green Heart ecosystem
Easy access to restrooms

Provisions:
Powerpoint

Rate: \$1,000 per day



B

CITY ROOM WEST TOWER

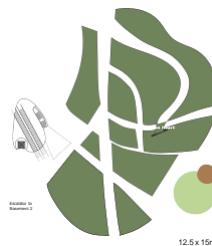

SPECIFICATIONS

Dimensions:
12.5m x 15m

Capacity:
Approx. 150 pax standing

Features:
Sheltered & natural cooling from
Marina One's Green Heart ecosystem
Easy access to restrooms

Provisions:
Powerpoint

Rate: \$1,000 per day



*Price quoted are for space rental only and before GST.

C

CITY ROOM PARK TOWER

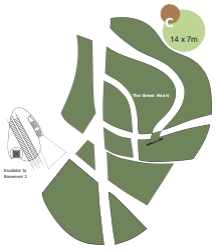

SPECIFICATIONS

Dimensions:
14m x 7m

Capacity:
Approx. 100 pax standing

Features:
Sheltered & natural cooling from
Marina One's Green Heart ecosystem
Easy access to restrooms

Provisions:
Powerpoint

Rate: \$800 per day



D

CITY ROOM GARDEN TOWER



SPECIFICATIONS

Dimensions:
13.6m x 12.3m (Fully Sheltered)
13.6m x 24.2m (Partial sheltered)

Capacity:
Approx. 150 pax standing

Features:
Sheltered & natural cooling from
Marina One's Green Heart ecosystem
Easy access to restrooms

Provisions:
Powerpoint

Rate: \$800 per day



*Price quoted are for space rental only and before GST.

MARINA ONE WEST TOWER

LEVEL 3

(Auditorium and Meeting Rooms)

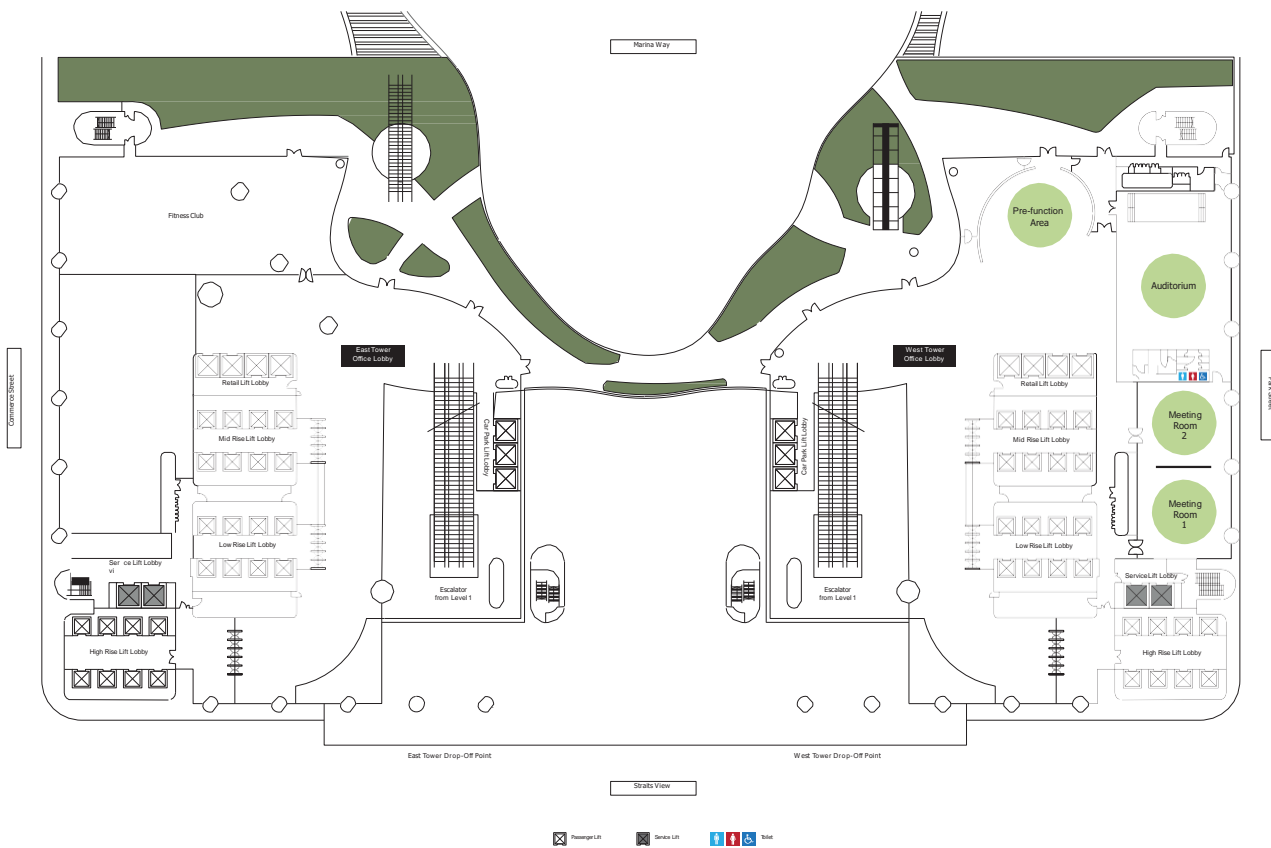

MARINA ONE WEST TOWER

LEVEL 3



MARINA ONE MEETING ROOM 1 OR 2

Capacity: Approximately 122 persons

(Mon to Fri)
8am to 6pm: **\$250/hr***
6pm to 10pm: **\$350/hr***

(Sat)
8am to 5pm: **\$350/hr***

Public: Min. 3 hours booking
Tenants: Min. 2 hours booking



MARINA ONE MEETING ROOM M (COMBINED)

Capacity: Approximately 244 persons

(Mon to Fri)
8am to 6pm: **\$425/hr***
6pm to 10pm: **\$525/hr***

(Sat)
8am to 5pm: **\$525/hr***

Public: Min. 3 hours booking
Tenants: Min. 2 hours booking



MARINA ONE AUDITORIUM

Capacity: Approximately 336 persons

(Mon to Fri)
8am to 6pm: **\$600/hr***
6pm to 10pm: **\$720/hr***

(Sat)
8am to 5pm: **\$720/hr***

Public: Min. 3 hours booking
Tenants: Min. 2 hours booking

VIP LOUNGE OR PRE-FUNCTION AREA

Capacity: Approximately 10 persons

(Mon to Sat)
8am to 10pm:
\$250/4 hours block (VIP Lounge)
\$500/4 hours block (Pre-function Area)



*All rates stated are inclusive of basic equipment, accessories and pre-function area (subject to availability). Subject to prevailing GST. For catering, the applicant has to cater food and drinks only from the F&B Tenants in Marina One.